

SWISSÔTEL EVENT CENTRE

- Upper Level: Registration, Club Rooms, and Exhibit Hall
- Lower Level: Ballrooms: Zurich A, Zurich BC, and Zurich DEFG

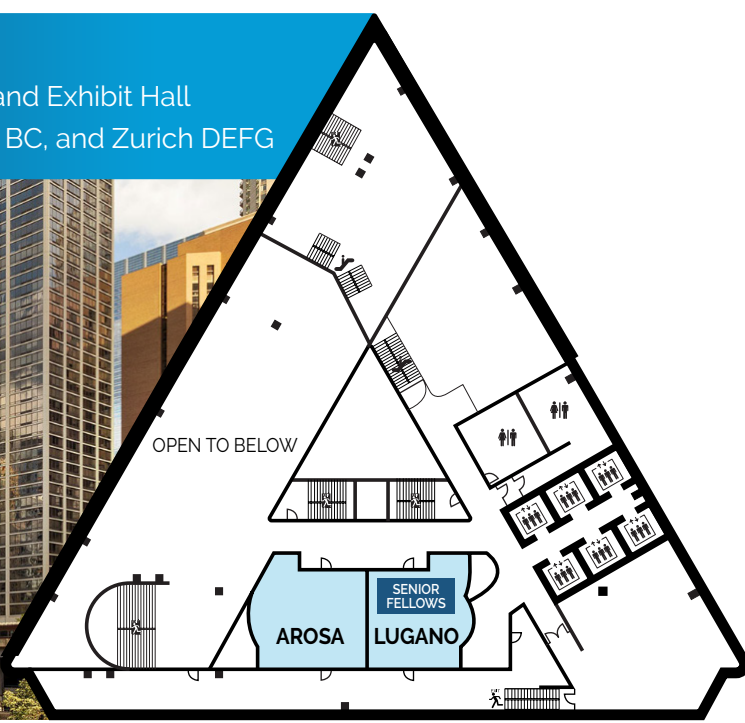
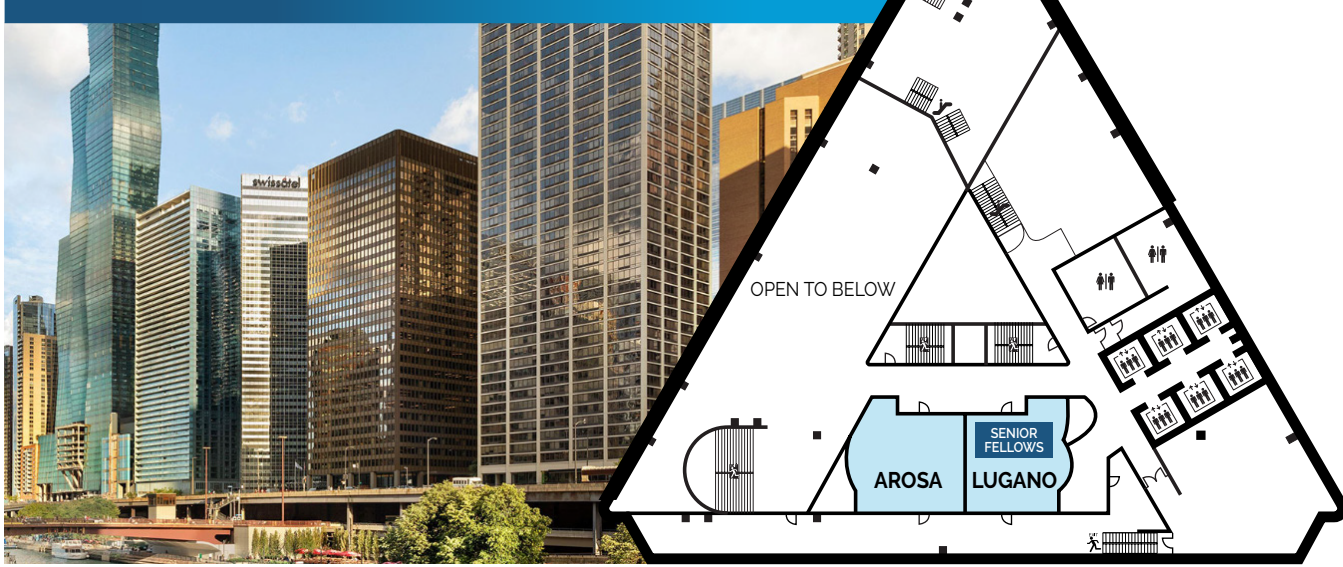

LEGEND

- Meeting Room or Ballroom
- Restrooms
- Escalator
- Elevator
- Emergency Exit
- Stairway

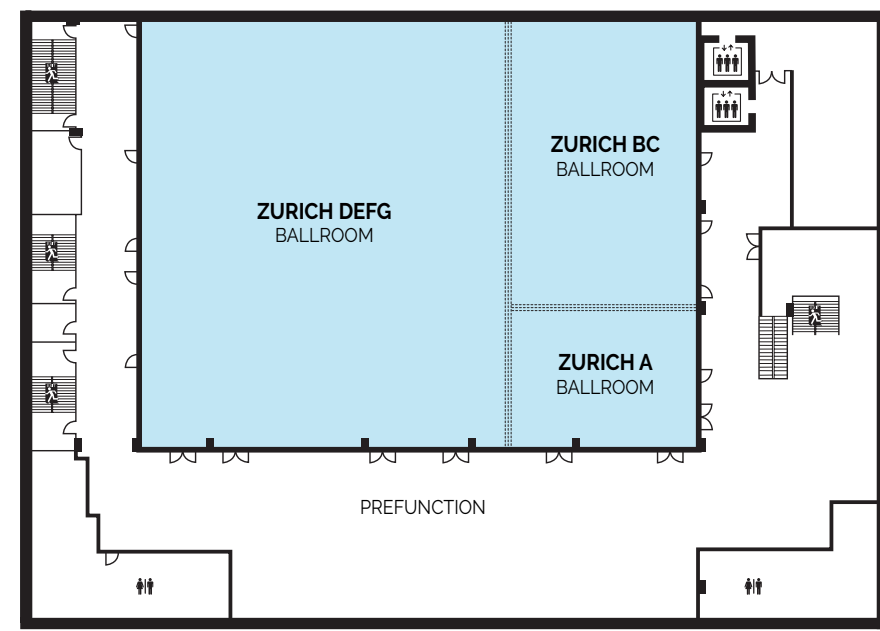
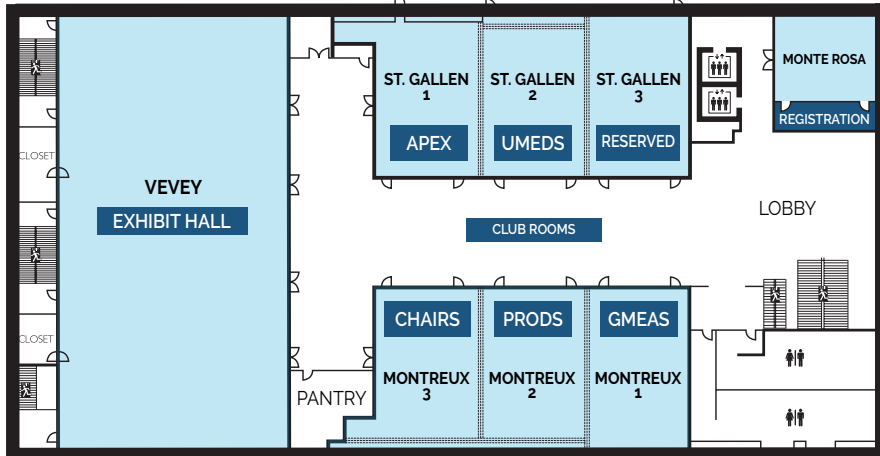

APC 2023 Annual Meeting

July 16 - 19, 2023
Swissôtel in Chicago, Illinois

Meeting Program Includes all programming by day for all Sections!

SUNDAY, JULY 16, 2023

PRE-CONFERENCE EVENTS

- 8:00a-5:00p Pathology Leadership Academy (separate registration required) [Alpine II]
- 8:00a-3:30p PIER Leadership Committee Meeting (by invitation only) [Arosa]
- 3:00p-4:30p Society of '67 Kinney Scholars and APEX Fellow Meet & Greet with Society of '67 Board (by invitation only) [St. Gallen 3]

CHAIRS

SAFE TRAVELS TO THE SWISSÔTEL CHICAGO!

- 4:00p-7:30p APC Registration Desk Open [Upper Level of Event Centre, Lobby]
- 4:00p-4:45p Meet & Greet for new Chairs and APC Leadership [Montreux 3: Chairs Club Room]
- 4:45p-5:00p APC Council Preview of Exhibits [Vevey]
- 5:00p-7:00p Opening Welcome Reception in Exhibit Hall [Vevey]

PRODS

SAFE TRAVELS TO THE SWISSÔTEL CHICAGO!

- 4:00p-7:30p APC Registration Desk Open [Upper Level of Event Centre, Lobby]
- 4:00p-5:00p Meet & Greet for new and first-time PRODS attendees with PRODS Council [Montreux 2: PRODS Club Room]
- 5:00p-7:00p Opening Welcome Reception in Exhibit Hall [Vevey]

APEX

SAFE TRAVELS TO THE SWISSÔTEL CHICAGO!

- 4:00p-7:30p APC Registration Desk Open [Upper Level of Event Centre, Lobby]
- 4:00p-5:00p Meet & Greet for new and first-time APEX attendees with APEX Council [St. Gallen 1: APEX Club Room]
- 5:00p-7:00p Opening Welcome Reception in Exhibit Hall [Vevey]

UMEDS

SAFE TRAVELS TO THE SWISSÔTEL CHICAGO!

- 4:00p-7:30p APC Registration Desk Open [Upper Level of Event Centre, Lobby]
- 4:00p-5:00p Meet & Greet for new and first-time UMEDS attendees with UMEDS Council [St. Gallen 2: UMEDS Club Room]
- 5:00p-7:00p Opening Welcome Reception in Exhibit Hall [Vevey]
- 6:00p-8:30p Educational Case Review Board (by invitation only) [St. Gallen 3]

GMEAS

SAFE TRAVELS TO THE SWISSÔTEL CHICAGO!

- 4:00p-7:30p APC Registration Desk Open [Upper Level of Event Centre, Lobby]
- 4:00p-5:00p Meet & Greet for new and first-time GMEAS attendees with GMEAS Council [Montreux 1: GMEAS Club Room]
- 5:00p-7:00p Opening Welcome Reception in Exhibit Hall [Vevey]

MONDAY, JULY 17, 2023

CHAIRS

- 7:15a-5:00p APC Registration Desk Open [Upper Level of Event Centre, Lobby]
- 7:30a-6:00p Exhibits Open [Vevey]
- 7:30a-8:30a Breakfast in Exhibit Hall [Vevey]
- 8:30a-10:00a Spouse/Guest hospitality breakfast available for registered Spouses/Guests [Hotel: Presidential Suite, 41st Floor]

PRODS

- 7:15a-5:00p APC Registration Desk Open [Upper Level of Event Centre, Lobby]
- 7:30a-6:00p Exhibits Open [Vevey]
- 7:30a-8:30a Breakfast in Exhibit Hall [Vevey]
- 8:30a-10:00a Spouse/Guest hospitality breakfast available for registered Spouses/Guests [Hotel: Presidential Suite, 41st Floor]

APEX

- 7:15a-5:00p APC Registration Desk Open [Upper Level of Event Centre, Lobby]
- 7:30a-6:00p Exhibits Open [Vevey]
- 7:30a-8:30a Breakfast in Exhibit Hall [Vevey]
- 8:30a-10:00a Spouse/Guest hospitality breakfast available for registered Spouses/Guests [Hotel: Presidential Suite, 41st Floor]

UMEDS

- 7:15a-5:00p APC Registration Desk Open [Upper Level of Event Centre, Lobby]
- 7:30a-6:00p Exhibits Open [Vevey]
- 7:30a-8:30a Breakfast in Exhibit Hall [Vevey]
- 8:30a-10:00a Spouse/Guest hospitality breakfast available for registered Spouses/Guests [Hotel: Presidential Suite, 41st Floor]

GMEAS

- 7:15a-5:00p APC Registration Desk Open [Upper Level of Event Centre, Lobby]
- 7:30a-6:00p Exhibits Open [Vevey]
- 7:30a-8:30a Breakfast in Exhibit Hall [Vevey]
- 8:30a-10:00a Spouse/Guest hospitality breakfast available for registered Spouses/Guests [Hotel: Presidential Suite, 41st Floor]

MONDAY, JULY 17, 2023

CHAIRS

- 8:30a-10:00a (C1) Chair (Leadership) Boot Camp: Leading During Challenging Times: Promoting and Enhancing Personal and Departmental Resilience [Zurich DEFG] Moderator: David Bailey, MD, Chair, Senior Fellow Group (UCSD) Speakers: C1.2 - Valerie Fitzhugh, MD (Rutgers Univ), C1.3 - Nancy Joste, MD (Univ of New Mexico), C1.4 - Steven Kroft, MD (Medical College of Wisconsin), C1.5 - Michael Laposata, MD, PhD (Univ of Texas Medical Branch), C1.6 - Roger Mitchell, MD (Howard Univ), C1.7 - Reflections, Fred Sanfilippo, MD, PhD (Emory Univ)
- 10:00a-10:30a Refreshment Break and Networking in Exhibit Hall [Vevey]
- 10:30a-12:00p Explore other Programs or Exhibits, or Mingle in the Chairs Club Room [Montreux 3]
- 12:00p-1:30p Lunch, Networking, Exhibits [Vevey]
- 12:15p-1:15p Featured Lunch Discussion for Vice Chairs of Education [St. Gallen 2] Bring lunch/beverage from Exhibit Hall
- 12:15p-1:15p Featured Lunch Discussion for Directors of Student (Post-Sophomore) Fellowships [Montreux 2] - Bring lunch/beverage from Exhibit Hall
- 12:15p-1:15p New Chairs Lunch with Senior Fellows (by invitation only) [St. Gallen 3] Bring lunch/beverage from Exhibit Hall
- 1:30p-3:00p (C2) Practice & Management Session: Recruiting and Retaining the Academic Laboratory Workforce in a Competitive Economy [Zurich DEFG] Moderator: Chen Liu, MD, PhD, Chair, P&M Committee (Yale Univ) Speakers: C2.1 - How to Retain Faculty in Pathology Departments of Academic Medical Centers, Michael Laposata, MD, PhD (Univ of Texas Medical Branch), C2.2 - Potential Benefits and Challenges of Integration, and the Implications for Education, Research, and Clinical Practice, Merce Jorda, MD, PhD, MBA (Univ of Miami), C2.3 - The Value of Feeling Connected to Colleagues in Retention, Lydia Howell, MD (Univ of California, Davis), C2.4 - Retaining and Recruiting Research Faculty and Physician-Scientists, Brian Smith, MD (Yale Univ), C2.5 - Compensation Tools to Support Recruitment and Retention: Introduction to APC's New Benchmarking Study, Chen Liu, MD, PhD, Chair, P&M Committee (Yale Univ)
- 3:00p-3:30p Refreshment Break and Networking in Exhibit Hall [Vevey]
- 3:30p-5:00p (C3) Research Session: Enabling and Incentivizing Research in Departments of Pathology [Zurich DEFG] Moderator: Nitin Karandikar, MD, PhD, Chair, Research Committee (Univ of Iowa) Speakers: C3.1 - Survey Results, Edwin Manuki, MD, PhD, Chair, PhD Program Leaders Committee (Univ of California, Irvine), C3.2 - ...in a Pathology Department, Clifford Harding, MD, PhD (Case Western Reserve Univ), C3.3 - ...at Dartmouth Hitchcock Health System and Geisel School of Medicine at Dartmouth, Gregory Tsongalis, PhD (Dartmouth Univ), C3.4 - ...at the University of Miami, David Lombard, MD, PhD (Univ of Miami), C3.5 - ...at the University of North Carolina, Yuri Fedariv, MD (Univ of North Carolina at Chapel Hill), C3.6 - ...at the University of Michigan, Zaneta Nikolovska-Coleska, PhD (Univ of Michigan)
- 4:30p-6:00p Networking Reception in Exhibit Hall [Vevey]
- 5:30p-6:30p P&M Discussion Session: Integrating Community-Based Practices into Academic Health Systems [St. Gallen 3] Facilitators: Chen Liu, MD, PhD, Chair, P&M Committee (Yale Univ), Karen Kaul, MD, PhD (NorthShore Univ HealthSystem), Michael Talbert, MD (Univ of Oklahoma)
- 6:00p-8:00p Senior Fellows Group Dinner (by invitation only) [Hotel Lobby Level: Palm Restaurant]

PRODS

- 8:30a-10:00a Explore other Programs or Exhibits, or Mingle in the PRODS Club Room! [Montreux 2]
- 10:00a-10:30a Refreshment Break and Networking in Exhibit Hall [Vevey]
- 10:30a-12:00p (P1) GME Essentials & Updates [Zurich DEFG] Moderator: Candice Black, DO, Chair, PRODS Council (Dartmouth Hitchcock Medical Center) Speakers: P1.1 - A Year in the Life of a Program Director, Candice Black, DO (Dartmouth-Hitchcock Medical Center), P1.2 - Program Coordinator Perspectives, Alexandra Murtha, GMEAS Chair (Univ of California San Diego), P1.3 - A Chair's Perspective, Douglas Miller, MD, PhD (Univ of Missouri), P1.4 - Updates from the ACGME, Cindy Riyad, PhD (Accreditation Council for Graduate Medical Education), P1.5 - Updates from the ABPath, Gary Procop, MD (American Board of Pathology), P1.6 - Updates from the Entrustable Professional Activities (EPA) Working Group, Bronwyn Bryant (Univ of Vermont), P1.7 - Updates from the ASCP Resident In-Service Examination (RISE), Jonathan Genzen, MD, PhD (Univ of Utah), P1.8 - Updates from the Organization of Program Director Associations (OPDA) of the Council of Medical Specialty Societies (CMSS), Von Samedy, MD, PhD (Univ of Colorado)
- 12:00p-1:30p Lunch, Networking, Exhibits [Vevey]
- 12:15p-1:15p Featured Lunch Discussion for Vice Chairs of Education [St. Gallen 2] Bring lunch/beverage from Exhibit Hall
- 12:15p-1:15p Featured Lunch Discussion for Directors of Student (Post-Sophomore) Fellowships [Montreux 2] Bring lunch/beverage from Exhibit Hall
- 1:30p-3:00p Explore other Programs or Exhibits, or Mingle in the PRODS Club Room! [Montreux 2]
- 3:00p-3:30p Refreshment Break and Networking in Exhibit Hall [Vevey]
- 3:30p-5:00p (P2) Professionalism and HR Legal Perspectives: Learning from Experiences [Zurich BC] Moderator: Scott Anderson, MD, Past Chair, PRODS Council (Univ of Vermont) Speakers: P2.1 - When a Resident is Involved in a Compliance Violation, Thomas Cummings, MD (Duke Univ), P2.2 - Residency Application and Professional Behavior Necessitating NRMP Waiver, Suzanne Powell, MD (Houston Methodist), P2.3 - Unprofessional Behavior of a Resident, Douglas Miller, MD, PhD (Univ of Missouri), P2.4 - How to Handle the Irregular Resident Step by Step, Wesley Naritoku, MD, PhD (Univ of Southern California)
- 4:30p-6:00p Networking Reception in Exhibit Hall [Vevey]
- 6:00p-8:00p PRODS Council Plus Dinner (by invitation only) [Hotel: Presidential Suite, 41st Floor]

APEX

- 8:30a-10:00a Explore other Programs or Exhibits, or Mingle in the APEX Club Room! [St. Gallen 1]
- 10:00a-10:30a Refreshment Break and Networking in Exhibit Hall [Vevey]
- 10:30-12:00p (A1) General Clinical Service Metrics in the Pathology Department [Zurich BC] Moderator: Gary Brown, Chair, APEX Council (Univ of Colorado) Speakers: A1.1 - Joann Li (Columbia Univ), A1.2 - Shanker Deonandan (Hofstra Univ/Northwell)
- 12:00p-1:30p Lunch, Networking, Exhibits [Vevey]
- 1:30p-3:00p (C2) Practice & Management Session: Recruiting and Retaining the Academic Laboratory Workforce in a Competitive Economy [Zurich DEFG] Moderator: Chen Liu, MD, PhD, Chair, P&M Committee (Yale Univ) Speakers: C2.1 - How to Retain Faculty in Pathology Departments of Academic Medical Centers, Michael Laposata, MD, PhD (Univ of Texas Medical Branch), C2.2 - Potential Benefits and Challenges of Integration, and the Implications for Education, Research, and Clinical Practice, Merce Jorda, MD, PhD, MBA (Univ of Miami), C2.3 - The Value of Feeling Connected to Colleagues in Retention, Lydia Howell, MD (Univ of California, Davis), C2.4 - Retaining and Recruiting Research Faculty and Physician-Scientists, Brian Smith, MD (Yale Univ), C2.5 - Compensation Tools to Support Recruitment and Retention: Introduction to APC's New Benchmarking Study, Chen Liu, MD, PhD, Chair, P&M Committee (Yale Univ)
- 3:00p-3:30p Refreshment Break and Networking in Exhibit Hall [Vevey]
- 3:30p-5:00p (A2) Incentive and Compensation Plans [Zurich A] Moderator: Marilea Grider, Secretary-Elect, APEX Council (Emory Univ) Speakers: A2.1 - Susan McCarthy (Univ of Southern California), A2.2 - Joey McCall (Univ of Oklahoma), A2.3 - Chris Cheney (Northwestern Univ), A2.4 - Joann Li (Columbia Univ)
- 4:30p-6:00p Networking Reception in Exhibit Hall [Vevey]
- 5:30p-6:30p P&M Discussion Session: Integrating Community-Based Practices into Academic Health Systems [St. Gallen 3] Facilitators: Chen Liu, MD, PhD, Chair, P&M Committee (Yale Univ), Karen Kaul, MD, PhD (NorthShore Univ HealthSystem), Michael Talbert, MD (Univ of Oklahoma)

UMEDS

- 8:30a-10:00a (U1) Teaching Modalities [Zurich A] Moderator: Melina Flanagan, MD, Chair, UMEDS Council (West Virginia Univ) Speakers: U1.1 - Optimal Use of Online Learning Modules for Medical Education, Jacqueline Birks-Gartman, MD (Johns Hopkins Univ), U1.2 - Serious Game Application to Transfusion Medicine Education for Generation Z, Nichole LePage, MD (Indiana Univ), U1.3 - Using Qualtrics Software to Enhance Pathology Teaching and Learning at the University of Minnesota, Cade Arries, MD (Univ of Minnesota), U1.4 - Teaching Modalities at University of California at Davis School of Medicine, Elham Vali Betts, MD and Kristin Olson, MD (Univ of California, Davis)
- See below for other pre-recorded presentations related to UMEDS Sessions!
- 10:00a-10:30a Refreshment Break and Networking in Exhibit Hall [Vevey]
- 10:30a-12:00p (U2) Integration of Pathology in the Undergraduate Medical Curriculum [Zurich A] Moderator: Melina Flanagan, MD, Chair, UMEDS Council (West Virginia Univ) Speakers: U2.1 - Weaving Pathology through the Pre-Clinical Curriculum: The University of Rochester Experience, Jennifer Findeis-Hosey, MD (Univ of Rochester), U2.2 - Better Together: The Power of Co-Teaching in an Integrated Pre-Clinical Curriculum, Jennifer Zepf, DO (Hackensack Meridian SOM), U2.3 - Integrating Pathology Content into Multidisciplinary Panel Case Study Sessions, Ashley Inman, MD and Rachel Mathis, MD (Indiana Univ), U2.4 - The Road Map to Patient-Centered Health Care: Following the Landmarks of Integrated Social Determinants of Health (SDOH) Concepts, Samar Hegazy, MD, PhD and Kellie Mullaney (Carle Illinois COM at the Univ of Illinois Urbana-Champaign)
- See below for other pre-recorded presentations related to UMEDS Sessions!
- 12:00p-1:30p Lunch, Networking, Exhibits [Vevey]
- 12:15p-1:15p Featured Lunch Discussion for Vice Chairs of Education [St. Gallen 2] Bring lunch/beverage from Exhibit Hall
- 12:15p-1:15p Featured Lunch Discussion for Directors of Student (Post-Sophomore) Fellowships [Montreux 2] - Bring lunch/beverage from Exhibit Hall
- 1:30p-3:00p (U3) Emerging Technologies in Undergraduate Medical Education [Zurich A] Speakers: U3.1 - Artificial Intelligence: The Next Paradigm Shift in Medical Education, Cornelius James, MD (Univ of Michigan), U3.2 - From Bots to Docs: Harnessing AI in the Undergraduate Med School Journey, Robert Homer, MD, PhD (Yale Univ)
- 3:00p-3:30p Refreshment Break and Networking in Exhibit Hall [Vevey]
- 3:30p-5:00p View the pre-recorded presentations related to the morning sessions (see below for content; access via the APC Learning Center), explore other Section Programs or Exhibits, or Mingle in the UMEDS Club Room! [St. Gallen 2] Speakers: U3.1 - Asynchronous Delivery of Female Genital Tract Content in the MS2 Preclinical Curriculum, Melina Flanagan, MD (West Virginia Univ), U3.2 - Enhancing Student Engagement in Pathology Labs Leveraging iClicker, Madelyn Lew, MD (Univ of Michigan), U3.3 - Teaching Modalities: Laboratory Preparation Quizzes in Pathology, Lynette Parker, MD (Uniformed Services Univ of the Health Sciences), U3.4 - Pathology Laboratory Sessions in the Pre-Clinical Medical Curriculum: Assessment of Construct and Effectiveness of Large Group and Case-Based Components, Philip Boyer, MD, PhD (East Carolina Univ), U3.5 - The Brody Pathology Mnemonic Challenge: Deploying and Stimulating the Use of Mnemonics in Undergraduate Medical Education, Philip Boyer, MD, PhD (East Carolina Univ), U3.6 - Pre-Clinical Pathology Education at the University of Missouri - Columbia: Pre-COVID, During COVID, and "After" COVID, Shellaine Frazier, DO (Univ of Missouri), U3.7 - A Required Exposure to Pathology Practice in the Surgery Clerkship, Abdallah Tiafif, MD, and Margaret Magid, MD (New York Univ)
- 4:30p-6:00p Networking Reception in Exhibit Hall [Vevey]
- 6:00p-8:00p UMEDS Council Dinner (by invitation only) [Hotel Lobby Level: Palm Restaurant]

GMEAS

- 8:30a-10:00a (G1) GMEAS Member Business Meeting [Zurich BC] Moderators: Alexandra Murtha, Chair, GMEAS Council (UCSD), Chelle Kozy, Past Chair (Orlando Regional), Beth Smith, Chair-Elect (Penn State Hershey) with GMEAS Council members. Agenda: Introduction to GMEAS Council, Activities, Mentorship, Resources (including the GMEAS listserv and Dropbox), ABC's of GME, Essentials, Ice Breaker
- 10:00a-10:30a Refreshment Break and Networking in Exhibit Hall [Vevey]
- 10:30a-12:00p (P1) GME Essentials & Updates [Zurich DEFG] Moderator: Candice Black, DO, Chair, PRODS Council (Dartmouth Hitchcock Medical Center) Speakers: P1.1 - A Year in the Life of a Program Director, Candice Black, DO (Dartmouth-Hitchcock Medical Center), P1.2 - Program Coordinator Perspectives, Alexandra Murtha, GMEAS Chair (Univ of California San Diego), P1.3 - A Chair's Perspective, Douglas Miller, MD, PhD (Univ of Missouri), P1.4 - Updates from the ACGME, Cindy Riyad, PhD (Accreditation Council for Graduate Medical Education), P1.5 - Updates from the ABPath, Gary Procop, MD (American Board of Pathology), P1.6 - Updates from the Entrustable Professional Activities (EPA) Working Group, Bronwyn Bryant (Univ of Vermont), P1.7 - Updates from the ASCP Resident In-Service Examination (RISE), Jonathan Genzen, MD, PhD (Univ of Utah), P1.8 - Updates from the Organization of Program Director Associations (OPDA) of the Council of Medical Specialty Societies (CMSS), Von Samedy, MD, PhD (Univ of Colorado)
- 12:00p-1:30p Lunch, Networking, Exhibits [Vevey]
- 1:30p-3:00p (G2) Spring/Summer Best Practices [Zurich BC] Moderator: Beth Smith, Chair-Elect, GMEAS Council (Penn State Health) Onboarding: G1.1 - Residency Programs, Kristina Smith, Secretary, GMEAS Council (Mayo Clinic), G1.2 - Residency and Fellowship Programs, Vikki Scott (Univ of Pennsylvania), Program Evaluation Committee (PEC) / Annual Program Evaluation (APE): G1.3 - Amy Bourgeois, Member-at-Large, GMEAS Council (Univ of Vermont), G1.4 - Latoshia Cowherd (Univ of Louisville)
- 3:00p-3:30p Refreshment Break and Networking in Exhibit Hall [Vevey]
- 3:30p-5:00p GMEAS Club Room Discussion: Professional Development [Montreux 1] Co-Moderators: Pamela Adam-Lewis, MBA, EdD, Member-at-Large, GMEAS Council (Virginia Commonwealth Univ), Alexandra Murtha, Chair, GMEAS Council (UCSD) Speakers: P2.1 - When a Resident is Involved in a Compliance Violation, Thomas Cummings, MD (Duke Univ), P2.2 - Residency Application and Professional Behavior Necessitating NRMP Waiver, Suzanne Powell, MD (Houston Methodist), P2.3 - Unprofessional Behavior of a Resident, Douglas Miller, MD, PhD (Univ of Missouri), P2.4 - How to Handle the Irregular Resident Step by Step, Wesley Naritoku, MD, PhD (Univ of Southern California)
- 4:30p-6:00p Networking Reception in Exhibit Hall [Vevey]

CHAIRS

7:15a-5:00p APC Registration Desk Open [Upper Level of Event Centre, Lobby]
7:30a-2:00p Exhibits Open [Vevey]
7:30a-8:15a Breakfast in Exhibit Hall [Vevey]
8:30a-10:00a Spouse/Guest hospitality breakfast available for registered Spouses/Guests [Hotel: Presidential Suite, 41st Floor]
8:30a-10:00a (C4) Undergraduate Medical Education Session: Models for Supporting, Compensating and Advancing Medical Educators [Zurich DEFG]
Moderator: Valerie Fitzhugh, MD, Chair, UME Committee (Rutgers Univ)
C4.1 - UME Academic Promotion: Challenges and Supporting Educators, Barbara Ritschel, MD (Uniformed Services Univ of the Health Sciences)
Keynote:
C4.2 - Medical Educators: Building Support with Intentionality, Majka Woods, PhD (Univ of Texas Medical Branch)
Panelists:
C4.3 - A View from Rutgers New Jersey Medical School, Maria Soto-Greene, MD (Rutgers Univ)
C4.4 - James Crawford, MD, PhD (Hofstra Univ/Northwell)
C4.5 - Guiding Faculty While Meeting Departmental and Institutional Needs, Michael Prystowsky, MD, PhD (Albert Einstein)
10:00a-10:30a Refreshment Break and Networking in Exhibit Hall [Vevey]
10:30a-12:00p (C5) Graduate Medical Education Session: Improving Trainee Experiences in Pathology Residency [Zurich DEFG]
Moderator: Douglas Miller, MD, PhD, GME Committee Chair (Univ of Missouri)
C5.1 - Updates on a Common Fellowship Application Timeline, Paul Staats, MD (Univ of Maryland)
C5.2 - Residency Curriculum Updates, Gary Procop, MD (ABPath)
C5.3 - Improving Trainee Experiences in Pathology Residency - EPA Perspective, Bronwyn Bryant, MD (Univ of Vermont)
12:00p-1:00p Lunch and Networking in Exhibit Hall [Vevey]
12:00p-1:00p Meet & Greet Lunch for the Academy of Distinguished Pathology Educators (by invitation only) [St. Gallen 3]
1:00p-2:45p (C6) Advocacy Session: Advocating Within Your System: Stewarding Precision Medicine Testing [Zurich DEFG]
Moderator: Steven Kraft, MD, Chair, Advocacy Committee (Medical College of Wisconsin)
Perspectives from a...
C6.1 - Medical Oncologist, J. Douglas Rizzo, MD (Medical College of Wisconsin)
C6.2 - Chief Medical Officer, Barbara Ducatman, MD (Beaumont Health)
C6.3 - Department Administrator, Matt Charles (NorthShore Univ HealthSystem)
C6.4 - Lab Director, Jennifer Morrisette, PhD (Univ of Pennsylvania)
APC 2023 Friends of Pathology Award [Zurich DEFG]
2:45p-3:00p Beverage Break [Zurich and Club Room Hallways]
3:00p-4:30p Chairs Business Meeting [Zurich BC]
4:30p-6:00p Meet & Greet for APC Diversity, Equity, and Inclusion (DEI) Faculty Leaders Network and Members of the Leadership Development & Diversity Committee [St. Gallen 3]
6:00p-8:00p Academic Pathology Associate Editors Meeting/Dinner with Elsevier (by invitation only) [Arosa]

PRODS

7:15a-5:00p APC Registration Desk Open [Upper Level of Event Centre, Lobby]
7:30a-2:00p Exhibits Open [Vevey]
7:30a-8:15a Breakfast in Exhibit Hall [Vevey]
7:30a-8:15a Q&A on the Resident In-Service Exam [Montreux 2]
8:30a-10:00a Spouse/Guest hospitality breakfast available for registered Spouses/Guests [Hotel: Presidential Suite, 41st Floor]
8:30a-10:00a Explore other Programs or Exhibits, or Mingle in the PRODS Club Room! [Montreux 2]
10:00a-10:30a Refreshment Break and Networking in Exhibit Hall [Vevey]
10:30a-12:00p (C5) Graduate Medical Education Session: Improving Trainee Experiences in Pathology Residency [Zurich DEFG]
Moderator: Douglas Miller, MD, PhD, GME Committee Chair (Univ of Missouri)
C5.1 - Updates on a Common Fellowship Application Timeline, Paul Staats, MD (Univ of Maryland)
C5.2 - Residency Curriculum Updates, Gary Procop, MD (ABPath)
C5.3 - Improving Trainee Experiences in Pathology Residency - EPA Perspective, Bronwyn Bryant, MD (Univ of Vermont)
12:00p-1:00p Lunch and Networking in Exhibit Hall [Vevey]
12:00p-1:00p Meet & Greet Lunch for the Academy of Distinguished Pathology Educators (by invitation only) [St. Gallen 3]
1:00p-2:45p Explore other Programs or Exhibits, or Mingle in the PRODS Club Room! [Montreux 2]
APC 2023 Friends of Pathology Award [Zurich DEFG]
2:45p-3:00p Beverage Break [Zurich and Club Room Hallways]
3:00p-4:30p (P3) ERAS Updates and Signal Tokens [Zurich DEFG]
Moderator: Deborah Chute, MD, Vice Chair, PRODS Council (Cleveland Clinic)
P3.1 - Changes in the ERAS Application System, Richard Peng, ERAS Program Relations Specialist, Lead, Association of American Medical Colleges
4:40p-5:30p (P4) PRODS Business Meeting, including Work Group Updates [Zurich DEFG]
P4.1 - Pathology Informatics Essentials for Residents (PIER) Updates, Scott Anderson, MD (Univ of Vermont)
P4.2 - Program Director Patient Safety and Quality (PDPQ) Educators Network Update, John Childs, MD (Geisinger Health)
P4.3 - Training Resident in Genomics (TRIG) Update, Richard Haspel, MD, PhD (Beth Israel Deaconess Medical Center)
P4.4 - Update from the Training Residents in Patient Safety (TRIPS) Working Group, Kristie White, MD (Univ of California, San Francisco)
P4.5 - Update on the CAP/APC Program Directors' Toolbox, Kristin Johnson, PhD (College of American Pathologists) and Amelia Stephenson (Association of Pathology Chairs)

APEX

7:15a-5:00p APC Registration Desk Open [Upper Level of Event Centre, Lobby]
7:30a-2:00p Exhibits Open [Vevey]
7:30a-8:15a Breakfast in Exhibit Hall [Vevey]
8:30a-10:00a Spouse/Guest hospitality breakfast available for registered Spouses/Guests [Hotel: Presidential Suite, 41st Floor]
8:30a-10:00a Explore other Programs or Exhibits, or Mingle in the APEX Club Room! [St. Gallen 1]
10:00a-10:30a Refreshment Break and Networking in Exhibit Hall [Vevey]
10:30-12:00p (A3) Administrative Salary Survey and Benchmarks [Zurich BC]
Moderator: Joann Li, Chair-Elect, APEX Council (Columbia Univ)
A3.1 - Gary Brown (Univ of Colorado)
A3.2 - John Baci (Boston Children's Hospital)
12:00p-1:00p Lunch and Networking in Exhibit Hall [Vevey]
1:00p-2:45p (C6) Advocacy Session: Advocating Within Your System: Stewarding Precision Medicine Testing [Zurich DEFG]
Moderator: Steven Kraft, MD, Chair, Advocacy Committee (Medical College of Wisconsin)
Perspectives from a...
C6.1 - Medical Oncologist, J. Douglas Rizzo, MD (Medical College of Wisconsin)
C6.2 - Chief Medical Officer, Barbara Ducatman, MD (Beaumont Health)
C6.3 - Department Administrator, Matt Charles (NorthShore Univ HealthSystem)
C6.4 - Lab Director, Jennifer Morrisette, PhD (Univ of Pennsylvania)
APC 2023 Friends of Pathology Award [Zurich DEFG]
2:45p-3:00p Beverage Break [Zurich and Club Room Hallways]
3:30p-4:30p (A4) APEX Business Meeting (in-person only) [Zurich A]
4:30p-6:30p APEX Launch Party [Hotel: Presidential Suite, 41st Floor] For all APEX members to gather and celebrate the new Section name change!

UMEDS

7:15a-5:00p APC Registration Desk Open [Upper Level of Event Centre, Lobby]
7:30a-2:00p Exhibits Open [Vevey]
7:30a-8:15a Breakfast in Exhibit Hall [Vevey]
8:30a-10:00a Spouse/Guest hospitality breakfast available for registered Spouses/Guests [Hotel: Presidential Suite, 41st Floor]
8:30a-10:00a (C4) Undergraduate Medical Education Session: Models for Supporting, Compensating and Advancing Medical Educators [Zurich DEFG]
Moderator: Valerie Fitzhugh, MD, Chair, UME Committee (Rutgers Univ)
C4.1 - UME Academic Promotion: Challenges and Supporting Educators, Barbara Ritschel, MD (Uniformed Services Univ of the Health Sciences)
Keynote:
C4.2 - Medical Educators: Building Support with Intentionality, Majka Woods, PhD (Univ of Texas Medical Branch)
Panelists:
C4.3 - A View from Rutgers New Jersey Medical School, Maria Soto-Greene, MD (Rutgers Univ)
C4.4 - James Crawford, MD, PhD (Hofstra Univ/Northwell)
C4.5 - Guiding Faculty While Meeting Departmental and Institutional Needs, Michael Prystowsky, MD, PhD (Albert Einstein)
10:00a-10:30a Refreshment Break and Networking in Exhibit Hall [Vevey]
10:30a-12:00p (U4) UMEDS Business Meeting (in-person only) [Zurich A]
12:00p-1:00p Lunch and Networking in Exhibit Hall [Vevey]
12:00p-1:00p Meet & Greet Lunch for the Academy of Distinguished Pathology Educators (by invitation only) [St. Gallen 3]
1:00p-2:30p (U5) Academic Scholarship [Zurich BC] Barbara Ritschel, MD (Uniformed Services Univ of the Health Sciences)
Educational Scholarship
Updates on the Pathology Competencies in Medical Education (PCME) and Educational Cases
APC 2023 Friends of Pathology Award [Zurich DEFG]
2:30p-3:00p Beverage Break [Zurich and Club Room Hallways]
3:00p-4:30p (P3) ERAS Updates and Signal Tokens [Zurich DEFG]
Moderator: Deborah Chute, MD, Vice Chair, PRODS Council (Cleveland Clinic)
P3.1 - Changes in the ERAS Application System, Richard Peng, ERAS Program Relations Specialist, Lead, Association of American Medical Colleges

GMEAS

7:15a-5:00p APC Registration Desk Open [Upper Level of Event Centre, Lobby]
7:30a-2:00p Exhibits Open [Vevey]
7:30a-8:15a Breakfast in Exhibit Hall [Vevey]
7:30a-8:15a Q&A on the Resident In-Service Exam [Montreux 2]
8:30a-10:00a Spouse/Guest hospitality breakfast available for registered Spouses/Guests [Hotel: Presidential Suite, 41st Floor]
8:30a-10:00a (G3) Fall/Winter Best Practices [Zurich BC] Moderator: Alexandra Murtha, Chair, GMEAS Council (Univ of California San Diego)
Recruitment
G2.1 - Using Padlet, Beth Smith, Vice-Chair, GMEAS Council (Penn State Health)
G2.2 - The Coordinator Role in Medical Student Education, Katie Horton (Univ of Maryland)
Clinical Competency Committees (CCC)
G2.3 - Best Practices for Clinical Competency Committees (CCC), Kristine Scheel, Member-at-Large, GMEAS Council (Medical College of Wisconsin)
G2.4 - Developing Digital Processes to Increase Efficiency and Productivity for the CCC Meeting, Heidi Martinez (Univ of California Los Angeles)
10:00a-10:30a Refreshment Break and Networking in Exhibit Hall [Vevey]
10:30a-11:15a GMEAS Club Room Discussion: New Innovations [Montreux 1]
Moderator: In-person: Beth Smith, Chair-Elect, GMEAS Council (Penn State Hershey)
11:15a-12:00p GMEAS Club Room Discussion: MedHub [Montreux 1]
Moderators: In-person: Alexandra Murtha Chair, GMEAS Council (Univ of California San Diego); Kristina Smith, Secretary, GMEAS Council (Mayo Clinic); Remote: Leslie Antinarella (Univ of Rochester)
12:00p-1:00p Lunch and Networking in Exhibit Hall [Vevey]
1:00p-2:30p GMEAS Club Room Discussion: Dealing with Difficult Leaders [Montreux 1]
Moderator: Beth Smith, Chair-Elect, GMEAS Council (Penn State Hershey)
2:30p-3:00p Beverage Break [Zurich and Club Room Hallways]
3:00p-4:30p (P3) ERAS Updates and Signal Tokens [Zurich DEFG]
Moderator: Deborah Chute, MD, Vice Chair, PRODS Council (Cleveland Clinic)
P3.1 - Changes in the ERAS Application System, Richard Peng, ERAS Program Relations Specialist, Lead, Association of American Medical Colleges
4:30p-6:00p GMEAS Reception [Montreux 1] Hosted by the College of American Pathologists (CAP)

SOCIETY OF '67 KINNEY SCHOLARS

7:30a-8:30a Debriefing Breakfast with Society of '67 Board Members (by invitation only) [St. Gallen 1]

CHAIRS

7:30a-8:00a Breakfast in Chairs Club Room [Montreux 3]
8:00a-10:00a APC Research Committee Meeting [Montreux 3]
10:00a-10:30a Coffee and Tea Break [Zurich and Club Room Hallways]
10:30a-12:00p (C7) Leadership Development & Diversity Session: Recognizing and Addressing Healthcare Disparities through the Lens of Academic Pathology [Zurich DEFG] Moderators: Amyn Rojiani, MD, PhD, Chair, LD&D Committee (Penn State Health) and Jenny Libien, MD, PhD (Downstate Health Sciences Univ), Vice Chair, LD&D Committee
C7.1 - Patricia Thomas Lecture: Health Disparities in the Incarceration System, Roger Mitchell, MD (Howard Univ)
C7.2 - COVID-19 Minority Community-Based Health Care Initiative, Meeting People Where They Are: A Pathology Laboratory Perspective, Ravindra Kolhe, MD, PhD (Medical College of Georgia at Augusta Univ)
C7.3 - Health Disparities in Lab Reference Value Calculations, Geoffrey Baird, MD, PhD (Univ of Washington)
12:15p-2:00p Awards Lunch [Vevey] - All registrants invited to attend!
2:00p = CHAIRS Program Adjourns
2:30p-5:00p APC Council Meeting [Hotel: Matterhorn, 42nd Floor] (by invitation only)
5:30p-7:30p APC Council and Section Chairs Dinner [The Gage] (by invitation only)

PRODS

7:30a-8:15a Featured Breakfast Discussion for Directors of Student (Post Sophomore) Fellowships, including those who may have interest [St. Gallen 2]
8:30a-10:00a (P5) C. Bruce Alexander Lecture: Competency Based Medical Education (CBME) for Pathology Residency - Insights from Programs in Canada [Zurich DEFG] Moderator: Candice Black, DO, Chair, PRODS Council (Dartmouth Hitchcock Medical Center)
P5.1 - Introduction of a Competency Based Anatomical Pathology Residency Training Program at Queen's University, Christopher Davidson, MD (Queen's Univ)
P5.2 - CBME for Pathology Residency, Christine Orr, MD (Queen's Univ)
P5.3 - Introducing CBME into a Large Anatomic Pathology Residency Program: Lessons Learned, Susan Done, MD, PhD, MBA (Univ of Toronto)
10:00a-10:30a Coffee and Tea Break [Zurich and Club Room Hallways]
10:30a-12:00p (C7) Leadership Development & Diversity Session: Recognizing and Addressing Healthcare Disparities through the Lens of Academic Pathology [Zurich DEFG] Moderators: Amyn Rojiani, MD, PhD, Chair, LD&D Committee (Penn State Health) and Jenny Libien, MD, PhD (Downstate Health Sciences Univ), Vice Chair, LD&D Committee
C7.1 - Patricia Thomas Lecture: Health Disparities in the Incarceration System, Roger Mitchell, MD (Howard Univ)
C7.2 - COVID-19 Minority Community-Based Health Care Initiative, Meeting People Where They Are: A Pathology Laboratory Perspective, Ravindra Kolhe, MD, PhD (Medical College of Georgia at Augusta Univ)
C7.3 - Health Disparities in Lab Reference Value Calculations, Geoffrey Baird, MD, PhD (Univ of Washington)
12:15p-2:00p Awards Lunch [Vevey] - All registrants invited to attend!
2:00p = PRODS Program Adjourns
2:30p-5:00p APC Council Meeting and PRODS Section Chair and Vice Chair [Hotel: Matterhorn, 42nd Floor] (by invitation only)
5:30p-7:30p APC Council and Section Chairs Dinner [The Gage] (by invitation only)

APEX

7:30a-8:15a Breakfast in APEX Club Room [St. Gallen 1]
8:30a-10:00a (A5) Hot Topics Roundtable Discussions [Zurich BC] Moderators: PDAS Council Members, Discussion topics include: digital pathology stories, staffing problems, interactions with medical staff, and service weeks.
10:00a-10:30a Coffee and Tea Break [Zurich and Club Room Hallways]
10:30a-12:00p Explore other Programs or continue the conversations in the APEX Club Room! [St. Gallen 1]
12:15p-2:00p Awards Lunch [Vevey] - All registrants invited to attend!
2:00p = APEX Program Adjourns
2:30p-5:00p APC Council Meeting and APEX Section Chair and Chair-Elect [Hotel: Matterhorn, 42nd Floor] (by invitation only)
5:30p-7:30p APC Council and Section Chairs Dinner [The Gage] (by invitation only)

UMEDS

7:30a-8:15a Breakfast in UMEDS Club Room [St. Gallen 2]
8:30a-10:00a (P5) C. Bruce Alexander Lecture: Competency Based Medical Education (CBME) for Pathology Residency - Insights from Programs in Canada [Zurich DEFG] Moderator: Candice Black, DO, Chair, PRODS Council (Dartmouth Hitchcock Medical Center)
P5.1 - Introduction of a Competency Based Anatomical Pathology Residency Training Program at Queen's University, Christopher Davidson, MD (Queen's Univ)
P5.2 - CBME for Pathology Residency, Christine Orr, MD (Queen's Univ)
P5.3 - Introducing CBME into a Large Anatomic Pathology Residency Program: Lessons Learned, Susan Done, MD, PhD, MBA (Univ of Toronto)
10:00a-10:30a Coffee and Tea Break [Zurich and Club Room Hallways]
10:30a-12:00p (C7) Leadership Development & Diversity Session: Recognizing and Addressing Healthcare Disparities through the Lens of Academic Pathology [Zurich DEFG] Moderators: Amyn Rojiani, MD, PhD, Chair, LD&D Committee (Penn State Health) and Jenny Libien, MD, PhD (Downstate Health Sciences Univ), Vice Chair, LD&D Committee
C7.1 - Patricia Thomas Lecture: Health Disparities in the Incarceration System, Roger Mitchell, MD (Howard Univ)
C7.2 - COVID-19 Minority Community-Based Health Care Initiative, Meeting People Where They Are: A Pathology Laboratory Perspective, Ravindra Kolhe, MD, PhD (Medical College of Georgia at Augusta Univ)
C7.3 - Health Disparities in Lab Reference Value Calculations, Geoffrey Baird, MD, PhD (Univ of Washington)
12:15p-2:00p Awards Lunch [Vevey] - All registrants invited to attend!
2:00p = UMEDS Program Adjourns
2:30p-5:00p APC Council Meeting and UMEDS Section Chair [Hotel: Matterhorn, 42nd Floor] (by invitation only)
5:30p-7:30p APC Council and Section Chairs Dinner [The Gage] (by invitation only)

GMEAS

7:30a-8:15a Breakfast in GMEAS Club Room [Montreux 1]
8:30a-10:00a (P5) C. Bruce Alexander Lecture: Competency Based Medical Education (CBME) for Pathology Residency - Insights from Programs in Canada [Zurich DEFG] Moderator: Candice Black, DO, Chair, PRODS Council (Dartmouth Hitchcock Medical Center)
P5.1 - Introduction of a Competency Based Anatomical Pathology Residency Training Program at Queen's University, Christopher Davidson, MD (Queen's Univ)
P5.2 - CBME for Pathology Residency, Christine Orr, MD (Queen's Univ)
P5.3 - Introducing CBME into a Large Anatomic Pathology Residency Program: Lessons Learned, Susan Done, MD, PhD, MBA (Univ of Toronto)
10:00a-10:30a Coffee and Tea Break [Zurich and Club Room Hallways]
10:30a-12:00p (G4) Reflections [Zurich BC]
Budgeting for Your Program, Pamela Adams-Lewis, MBA, EdD, Member-at-Large, GMEAS Council (Virginia Commonwealth Univ), Amy Bourgeois, Member-at-Large, GMEAS Council (Univ of Vermont); Arisleyda Infante (Univ of Miami)
Debriefing the GMEAS Program, GMEAS Council Members
Goodie Bags to be distributed!
12:15p-2:00p Awards Lunch [Vevey] - All registrants invited to attend!
2:00p = GMEAS Program Adjourns
5:30p-7:30p APC Council and Section Chairs Dinner [The Gage] (by invitation only)